

THE CITY OF NAPOLEON

BUILDING & ZONING DEPARTMENT

255 W. RIVERVIEW

(419)592-4010

Building Permit

Permit Number: BP2009-15

Page 1 of 1

Printed: 3/26/2009

ADDRESS:

646 Appian

Applicant

Name: RBA of Minnesota

Address: 37720 Amrhein

Approval Date: 3/26/2009

734-237-1052

Owners

Name: J Creager

Address: 646 Appain

Napoleon, OH 43545

Phone: 419-592-5799

Contractors

Contractor Type: Builder

Name: RBA of Minnesota

Address: 37720 Amrhein

Livonia, Mi 48150

Phone: 734-237-1052

Fees and Receipts:

Number	Description	Amount
FEE2009-189	Windows/Doors (Auto)	\$9.00
FEE2009-190	State 1% fee (Calc)	\$0.09
Total Fees:		\$9.09
RCPT2009-166		\$9.09
Total Receipts:		\$9.09

Replace 4 Windows

APPLICANTS SIGNATURE: _____ DATE: _____

REMINDER: YOU MUST CALL (419)592-4010 FOR AN INSPECTION

CITY OF NAPOLEON GENERAL PERMIT APPLICATION

Bath # 20281

THIS APPLICATION IS FOR RESIDENTAL CONSTRUCTION INCLUDING BUILDING, ELECTRICAL, PLUMBING, MECHANICAL, DEMOLITIONS, & REMODELING.

DATE: 2/9/09 JOB LOCATION: 646 APPIAN

OWNER: J. CREAGER PHONE: 419-592-5799

OWNER ADDRESS: 646 APPIAN CITY: NAPOLEON ZIP: 43545

CONTRACTOR: RBA OF MINNESOTA

PHONE #: 734-237-1052 CELL PHONEN: 248-996-7119

CONTRACTOR LICENSED WITH THE CITY OF NAPOLEON?: YES NO:

Is any of the above job going to be subcontracted out? Yes No:

If yes to whom: NOT DETERMINED

DESCRIPTION OF WORK TO BE PERFORMED: REPLACEMENT WINDOWS- NO CHANGE
ESTIMATED COMPLETION DATE: 1 DAY INSTALLATION - NOT TO OPENINGS
SCHEDULED YET.

PLEASE MARK THE TYPE OF WORK YOU WILL BE PERFORMING

- | | |
|--|---|
| <input type="checkbox"/> A/C ADD ON 1% | <input type="checkbox"/> REMODELING 1% |
| <input type="checkbox"/> BOILER REPLACEMENT 1% | <input type="checkbox"/> ROOFING 1% |
| <input type="checkbox"/> CURBING | <input type="checkbox"/> SEWER REPAIRS** |
| <input type="checkbox"/> DECKS * 1% | <input type="checkbox"/> SIDEWALK* |
| <input type="checkbox"/> DRIVEWAY* | <input type="checkbox"/> SIDING 1% |
| <input type="checkbox"/> ELECTRICAL SERVICE UPGRADE 1% | <input type="checkbox"/> SHED* (under 200 sq ft) |
| <input type="checkbox"/> ELECTRICAL SERVICE NEW 1% | <input type="checkbox"/> SHED* (over 200 sqft) 1% |
| <input type="checkbox"/> SWIMMING POOL* 1% | <input type="checkbox"/> FENCE* |
| <input type="checkbox"/> FURNACE REPLACEMENT 1% | <input type="checkbox"/> TEMP ELECTRIC 1% |
| <input type="checkbox"/> ADDITIONS* 1% | <input type="checkbox"/> FURNACE NEW 1% |
| <input type="checkbox"/> WATER TAP (size _____") | <input checked="" type="checkbox"/> WINDOWS /DOORS 1% |
| <input type="checkbox"/> LAWN METER 1% | |
| <input type="checkbox"/> PLUMBING 1% | |

1% - EFFECTIVE JUNE 1, 2007 BOARD OF BUILDING STANDARDS FEE

*PLEASE INCLUDE A PICTURE SHOWING MEASUREMENTS FROM EXISTING STRUCTURES AND PROPERTY LINES. INDICATING THE TYPE OF WORK YOU WISH TO PERFORM.

** IF WORK REQUIRES GOING INTO THE STREET A STREET BOND IS REQUIRED!

FOR PERMIT COSTS PLEASE FILL OUT REVERSE SIDE.

OFFICE USE ONLY
PERMIT# _____
DUE \$ _____

PERMIT COST WORKSHEET

JOB

BASE FEE TOTAL + BBS FEE = PERMIT TOTAL

10%

SIDING (only) TOTAL SQ _____ X 1.00 = _____ + \$5.00 = \$ _____ + \$ _____ = \$ _____
ROOFING (only) TOTAL SQ _____ X 1.00 = _____ + \$5.00 = \$ _____ + \$ _____ = \$ _____
WINDOWS / DOORS(only) # <u>4</u> X 1.00 = <u>4.00</u> + \$5.00 = \$ <u>9.00</u> + \$ <u>.09</u> = \$ <u>9.09</u>
ELECTRICAL # OF CIRCUITS _____ X 3.00 = _____ + \$15.00 = \$ _____ + \$ _____ = \$ _____
ELECTRICAL SERVICE UPGRADE \$15.00 = \$ _____ + \$ _____ = \$ _____
PLUMBING (INSIDE) replacing/ repairs \$10.00 = \$ _____ + \$ _____ = \$ _____
SEWER (OUTSIDE) \$25.00 = \$ _____ + \$ N/A = \$ _____
WATER HEATER \$5.00 = \$ _____ + \$ _____ = \$ _____
SHED UNDER 200 SQ FT (over 200 see chart) \$ 5.00 = \$ _____ + \$ N/A = \$ _____
FURNACE OR A/C (REPLACEMENT) \$ 5.00 = \$ _____ + \$ _____ = \$ _____
DEMOLITION (only) \$30.00 N/A \$ _____
SIDEWALK REPLACEMENT/ NEW \$25.00 N/A \$ _____
DRIVEWAY \$25.00 N/A \$ _____

ALL CONSTRUCTION, ALTERATIONS, REMODELING, SHEDS, DECKS, & FENCES NOT LISTED ABOVE IS BASED ON COST OF WORK BEING PERFORMED.D.

COST OF WORK \$ _____ (SEE CHART) \$ _____ + \$ _____ = \$ _____

0.00 -	250.00	0.00	11,000.00 -	11,999.00	25.00
250.00 -	999.00	10.00	12,000.00 -	12,999.00	28.00
1,000.00 -	1,999.00	12.00	13,000.00 -	13,999.00	27.00
2,000.00 -	2,999.00	14.00	14,000.00 -	14,999.00	28.00
3,000.00 -	3,999.00	16.00	15,000.00 -	15,999.00	29.00
4,000.00 -	4,999.00	18.00	16,000.00 -	16,999.00	30.00
5,000.00 -	5,999.00	19.00	17,000.00 -	17,999.00	31.00
6,000.00 -	6,999.00	20.00	18,000.00 -	18,999.00	32.00
7,000.00 -	7,999.00	21.00	19,000.00 -	19,999.00	33.00
8,000.00 -	8,999.00	22.00	20,000.00 -	20,999.00	34.00
9,000.00 -	9,999.00	23.00	21,000.00 -	21,999.00	35.00
10,000.00 -	10,999.00	24.00	22,000.00 -	22,999.00	36.00
			Over 22,999	Please Call	

*** OTHER FEES NOT LISTED MAY APPLY

TOTAL PERMIT COSTS \$ 9.09

River

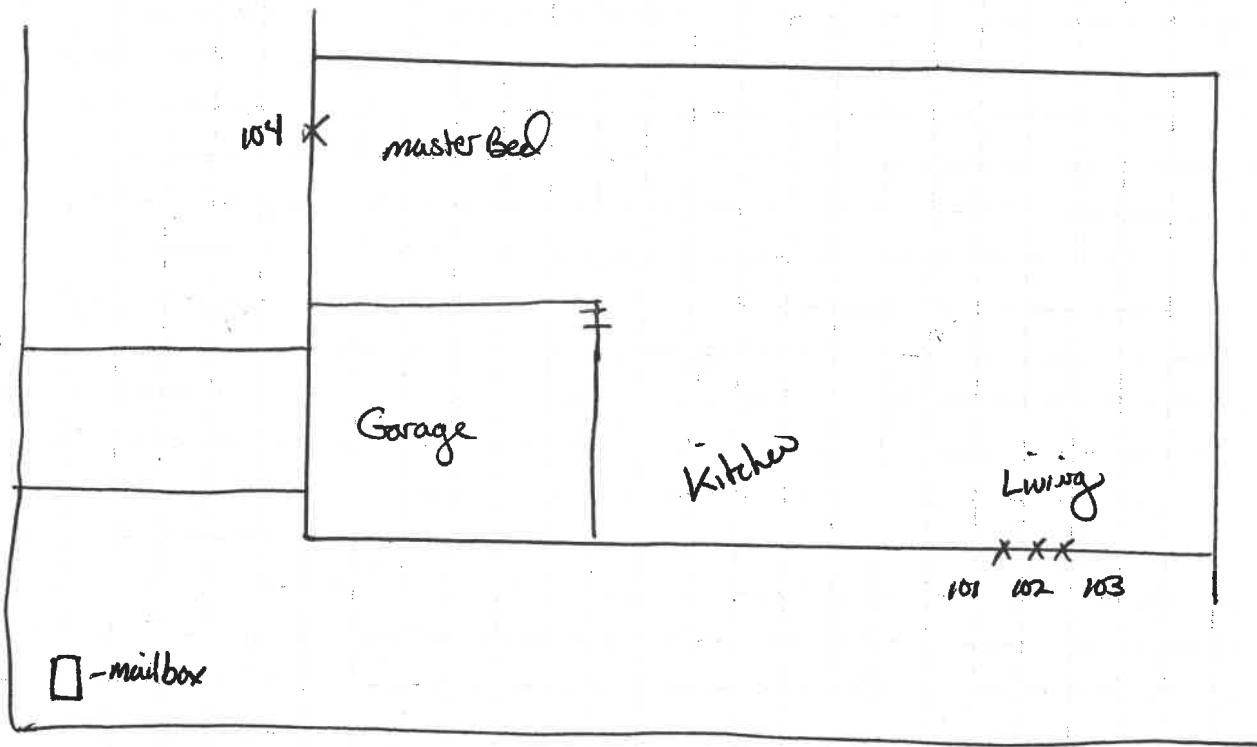

Appian St